

Setting Up Windows 10

1. Select the Language: English (United States)
2. Select the region: United States. Click YES.

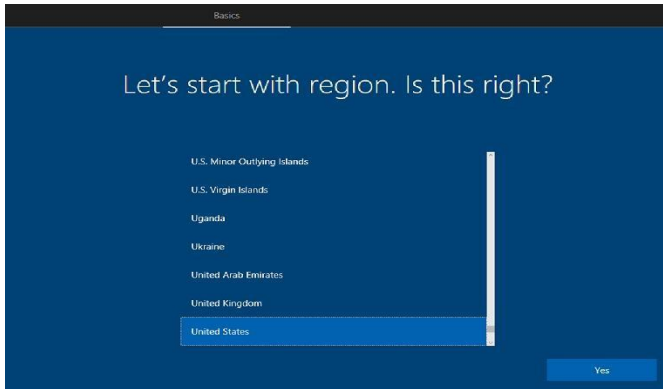

3. Select: US keyboard, and click YES.

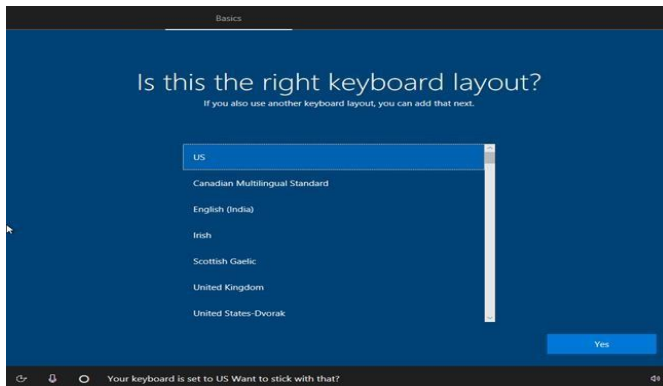

4. If you want to add a second keyboard for a different language, add one at this time. Otherwise, click SKIP.

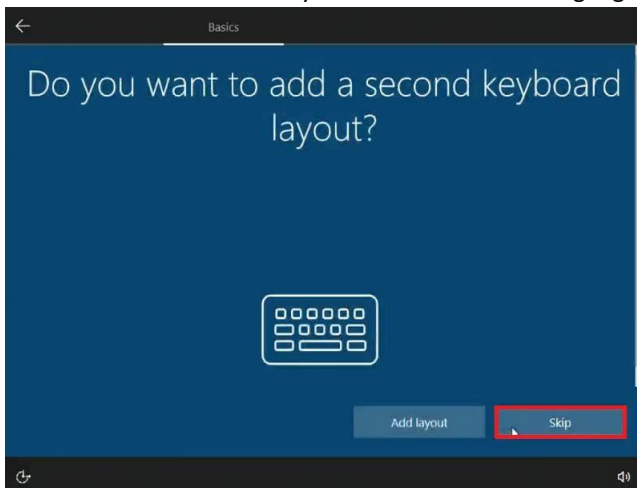

5. Instead of connecting to a network, click **SKIP FOR NOW**. You can connect to the internet later, once the account is set up. When prompted to “Connect now to save time later, click **NO**.”

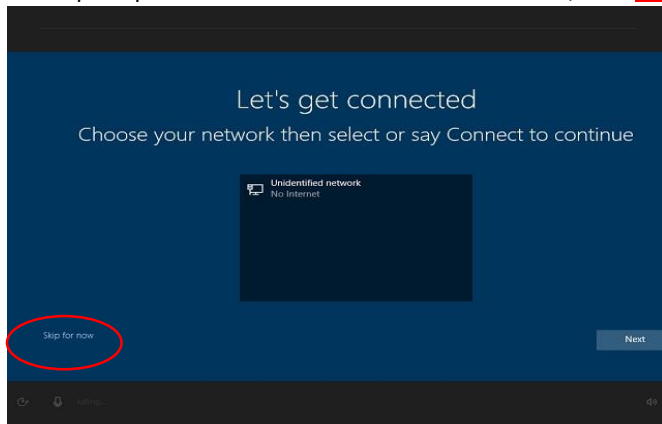

- a. If you accidentally connected to the network first, it will prompt you to login with a Microsoft Account. SJU Microsoft accounts are not setup to enroll for login purposes to be used at this screen. If you have a Microsoft account already, or a Hotmail, OneDrive, Outlook.com, or MSN.com account, it can be used to “Set up for Personal Use.”

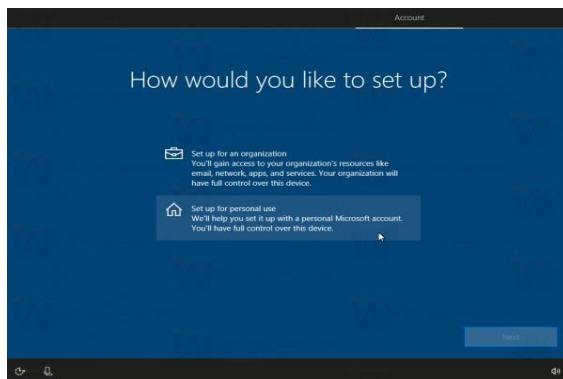

- b. If you do not have a personal Microsoft account already, one can be created and added later. Click the OFFLINE ACCOUNT link in the lower left corner.

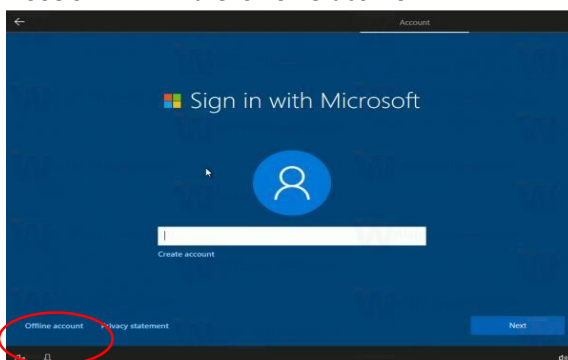

- c. It will confirm that you don't want to sign in with a Microsoft Account. Click NO.

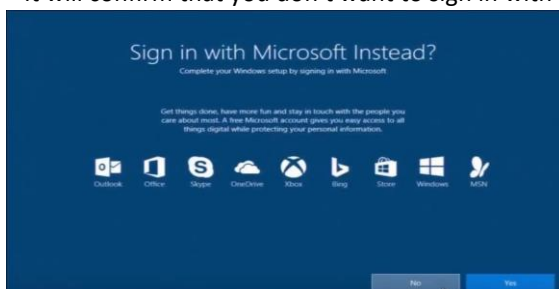

- Click ACCEPT to the Windows 10 License Agreement.
- Create a username to use to login to the computer. Then, Click NEXT.

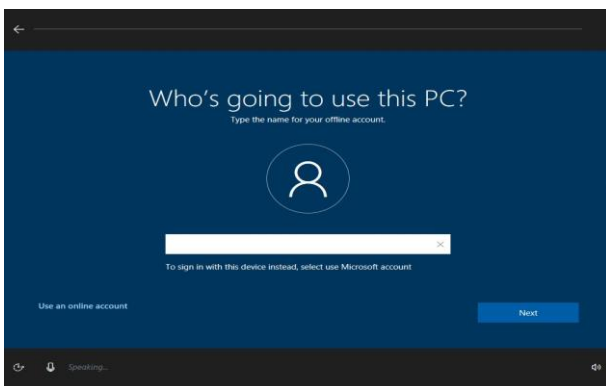

- Create a password that you will be able to remember. We won't be able to reset it for you. Click NEXT.

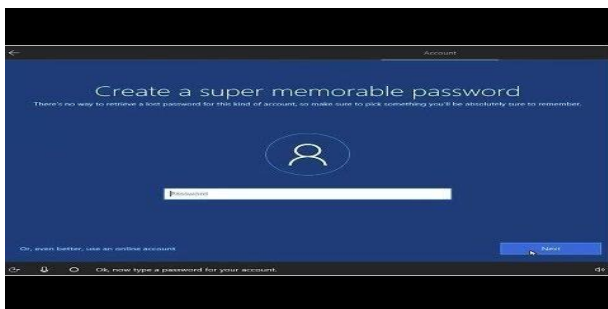

- Cortana is a Windows version of Siri. You can click YES, if you want to enable it.

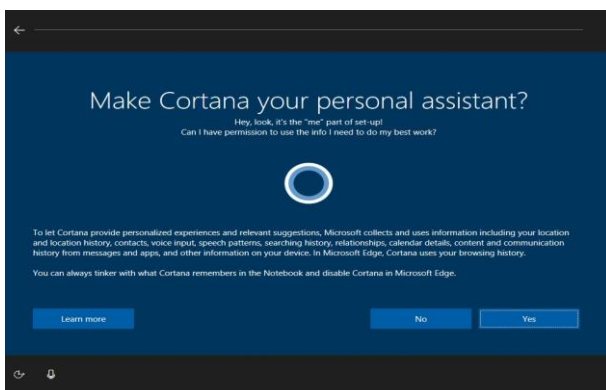

- If you wish to connect a Microsoft account do this laptop, that you already have connected to another device and wish to share your history between devices, you can choose YES. Otherwise, choose NO.

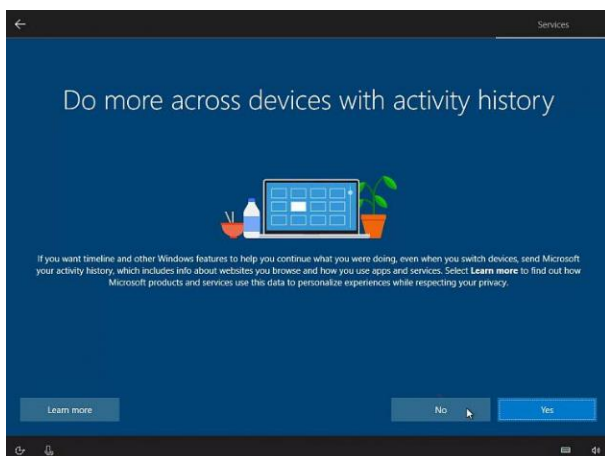

11. Click ACCEPT to privacy settings.

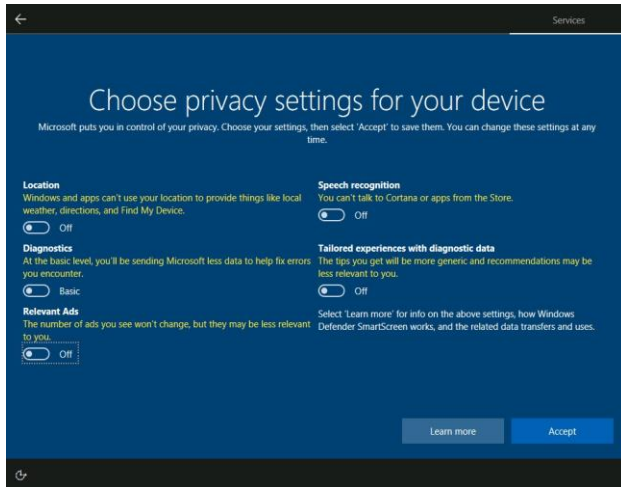

12. You will be prompted to "Protect Your Device", by creating a Lenovo ID. If you don't want to set this up, click SKIP.

13. Windows will complete your set up, and then load to the desktop.

